



Solar Powered Louvered Wall Fan



SUNNY INTERNATIONAL POWER LTD

Product Description

SIPL Solar Louvered Wall Fan is a green solar powered wall mounted axial flow exhaust fan, driven by brushless DC motor and run for air exchanging, to improve indoor ventilation freely by enjoying the generous sunlight.

Functions

- Strengthen air circulation
- Deduct harmful mildews
- Remove heat, moisture, dust, odor
- Solar DC powered, no rely on grid power
- Efficient power backup for running 24h

Advantages

- Solar powered at zero electricity cost
- DIY easy installation & wiring
- Operation quietly & efficiently
- Energy saving & eco-friendly
- Good BLDC motor for longer lifespan
- Once Pay, Benefit Long

Application

- Living room / Bathroom / Kitchen
/ Study room / Garage / Basement
- Recreation Room / Office
/ Hotel / Restaurant

Serves Well Everywhere

Suits All Kinds of Building Installation

Go Green Life throughout 24h!



Exhaust Fan

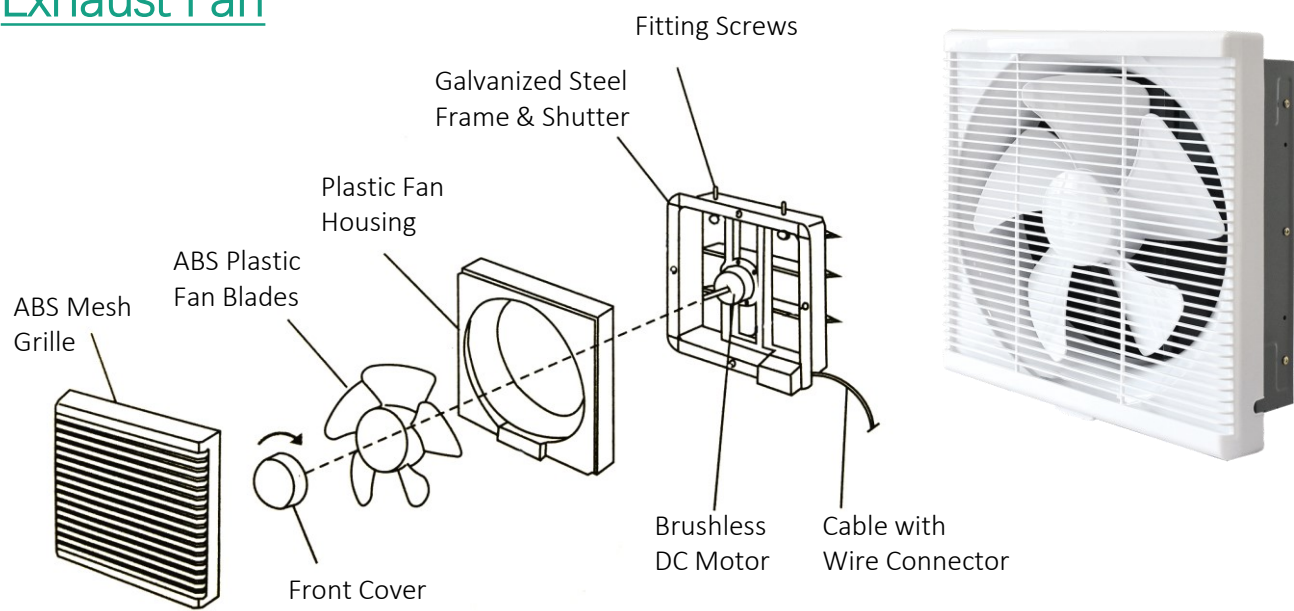

➤ Dimension Table

Option #	A (MM)	B (MM)	C (MM)	D (MM)	E (MM)	Mounting Hole (MM)
10''	336	336	55	75	290	300*300
12''	387	387	57	85	343	350*350

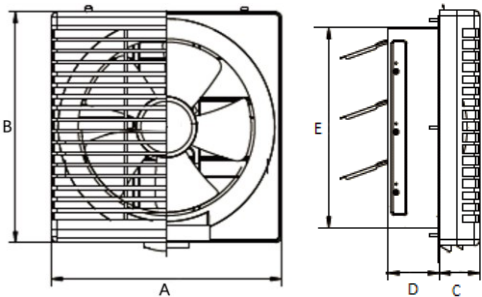

➤ Fan Motor Parameter

#78mm Brushless DC Motor	
Voltage	6~21V
Power	≤ 40W
Diameter	78mm
Motor Speed	30-1750RPM per solar panel input
IP Rate	IP63
Sound	Quiet (< 45dB)
Designed Lifetime	10 years

Long time lifespan,
High energy efficiency!



Solar Panel

- 30W / 40W polycrystalline solar module
- Tiltable and adjustable design with mounting base and brackets
- Waterproof wire connector to connect with fan
- Can connect with extra solar charged battery for night use



Option #	L (MM)	W (MM)	H (MM)	Battery	Function
30W	495	415	25	/	for solar ventilator working in sunny day periods
40W	495	495	25		

➤ Solar Charged Battery

The solar battery collects & stores solar energy at day time to support the solar ventilator work continuously after sunset.

Specifications of Solar Battery	
Solar Panel	40W 19.5V monocrystalline solar module
	415x495x67mm
Inbuilt Battery	Lithium iron phosphate battery
Battery Capacity	9.6Ah; full charged in 5.5 hours under strong sun
Battery Discharge	19~21 hours
Operating Temperature	-20~60℃
Cycle Life	2000 times

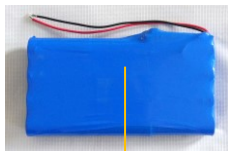

Model Selection

Day Time Freely Running Solar Wall Exhaust Fan



fan auto-runs powered by solar panel in sunny hours, when sunlight is available



Models#	Solar Panel	Air Duct (dia.)	Mounting Hole	Air Flow	Work Time	Power Source
SN2015008	30W /19.5V	10''	300x300mm	550CFM	Sunny hours	Solar panel
SN2015009	40W /21V	12''	350x350mm	980CFM		

Day & Night Time Nonstop Running Solar Wall Exhaust Fan



fan auto-runs powered by solar panel in sunny hours, and keeps running by auto-switching to grid power in sunless time



Models#	Solar Panel	Air Duct (dia.)	Mounting Hole	Air Flow	Work Time	Backup Energy
SN2016021	30W /19.5V	10''	300x300mm	550CFM	Day & night 24 hours	18V * 1.5A AC/DC adapter
SN2016023	40W /21V	12''	350x350mm	980CFM		

Day & Night Time Nonstop Freely Running Solar Wall Exhaust Fan



fan auto-runs powered by solar panel in sunny hours, and keeps running by auto-switching to battery in sunless time



Models#	Solar Panel	Air Duct (dia.)	Mounting Hole	Air Flow	Work Time	Backup Energy
SN2016022	70W (30W/19.5V + 40W/19.5V)	10''	300x300mm	550CFM	Day & night	16V 9.6Ah Solar battery
SN2016024	80W (40W/ 21V + 40W/ 19.5V)	12''	350x350mm	980CFM		

Switch Options

	<p><u>Remote Controller</u></p> <p>A wireless remote switch to make solar fan run/ stop most flexibly at any time, includes On/Off & 2hrs/4hrs Time Off functions; the fan will resume running automatically after 12 hours from the remote setting time; One-to-many control is workable within 15m.</p>
	<p><u>Snap-action Thermostat</u></p> <p>Attaching a thermostat to have the solar fan run/ stop mechanically at preset temperature.</p> <p>[25°C thermostat] On: 25°C +/-3°C; Off: 18°C +/-5°C [28°C thermostat] On: 28°C +/-3°C; Off: 21°C +/-5°C</p>
	<p><u>Manual Switch with Power Cord</u></p> <p>A manual switch is added to have the solar fan on / off flexibly as per your need.</p>
	<p><u>Adjustable Thermostat with Bypass Switch</u></p> <p>An adjustable thermostat (0°C~50°C / 50°F~122°F) and a bypass switch are combined to make solar fan run/ stop more flexibly at any time; the switch button can bypass thermostat to always have the fan ON; include 2m cable to connect with fan.</p>

More Fan Accessory

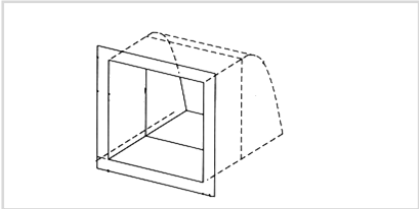

Outdoor Hood, such kind of hoods are supposed easy to find from local market, so they are not among our regular accessory list, but if you need them also from us, please let us know.

Solar Ventilation System

Several wall exhaust fans can be powered by one big solar panel.

So now you can customize a solar ventilation system per your need, to let your space breathe freely by enjoying the generous sunlight!

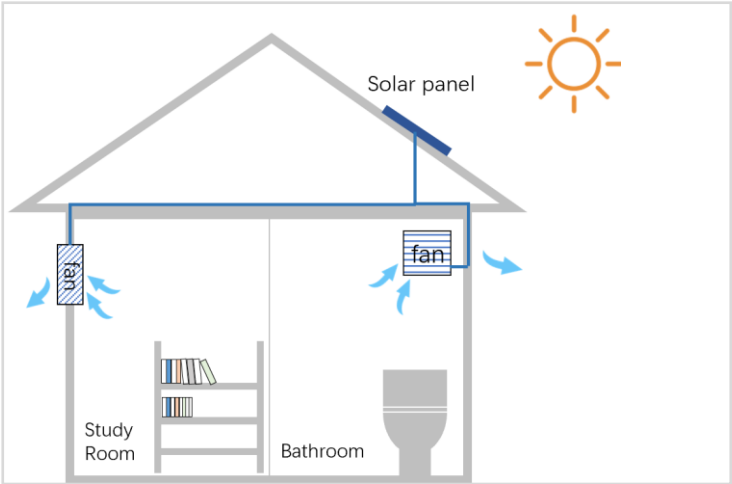

Warranty

Product Part	Designed Lifespan	Warranty
Plastic / Metal Casing	8 Years	5 Years
Solar Panel	25 Years	15 Years
Brushless DC Motor	> 10 Years	5 Years
Lithium Battery	8 Years	2 Years
AC/DC Adapter	8 Years	2 Years

The hereby lifespan & warranty terms are based on the product be used in regular residential housings, but not in those too humid or extreme condition places with acid and alkali corrosive gas / liquids.

Contact us

Thanks for your kind attention on our solar products.
Please feel free to contact us for any further inquiry.



SUNNY INTERNATIONAL POWER LTD

Tel: 0086 750-6219188 Fax: 0750-6219198

Email: sales@sunnyintlpowerltd.com

Website: www.sunnyintlpowerltd.com

www.sipl.en.alibaba.com



Enjoy the sunlight, and stay
cool with SIPL solar fans!



We believe solar innovation makes a
better place to live, for both us and
future generations...